

GPR-388

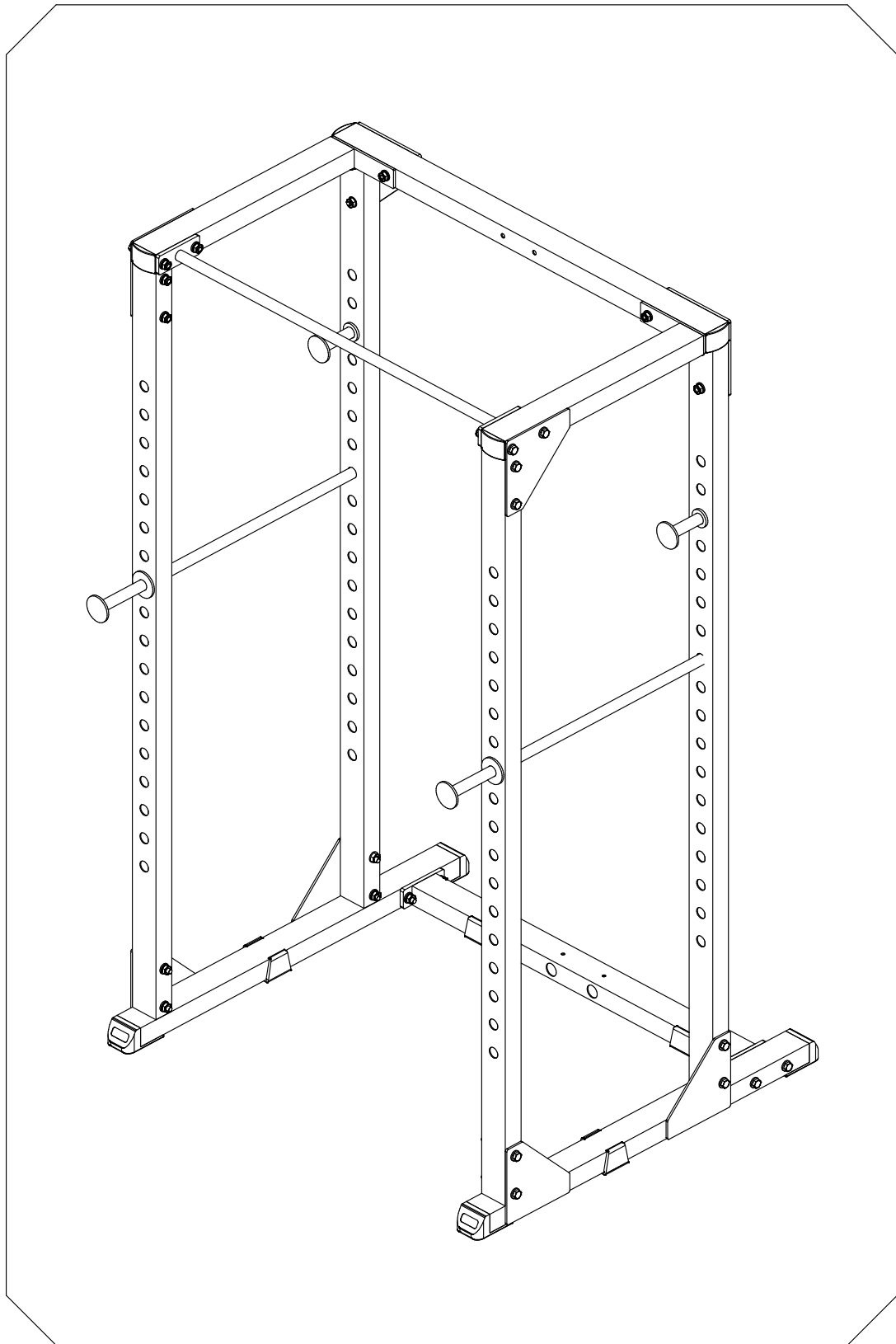

OWNER'S MANUAL

GPR-388 HARDWARE ILLUSTRATION SEET

A1.M12X110L HEX HEAD BOLT-----[8PCS]

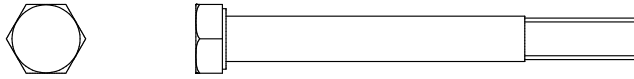

A2.M12X75L HEX HEAD BOLT-----[4PCS]

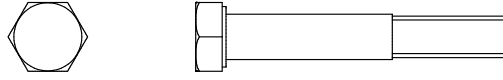

A3.M12X105L HEX HEAD BOLT-----[12PCS]

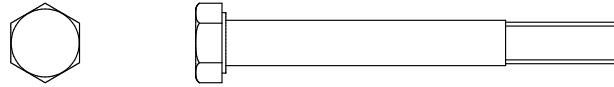

A4.M12X100L HEX HEAD BOLT-----[4PCS]

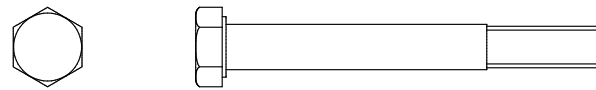

B1.M12 NYLON LOCK NUT-----[26PCS]



C1.M12 (Ø25) WASHER-----[54PCS]

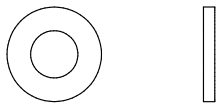

D1.END CAP (9211-084)-----[4PCS]



D2.END CAP (9211-026)-----[4PCS]

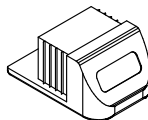

D3.Ø10X35 PIN (8250-014)-----[4PCS]



D4.RUBBER DOUNT (9212-011)-----[4PCS]

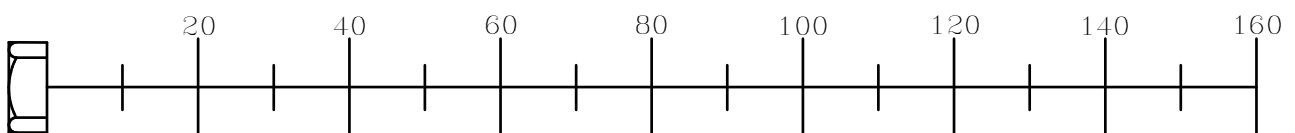
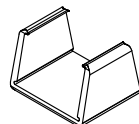

GPR-388 PARTS ILLUSTRATION SEET

A [1PCS]

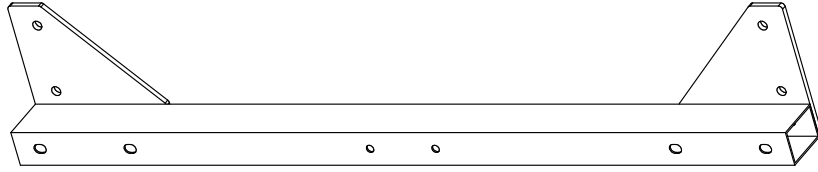

B [2PCS]

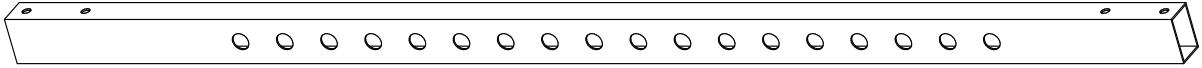

N [2PCS]

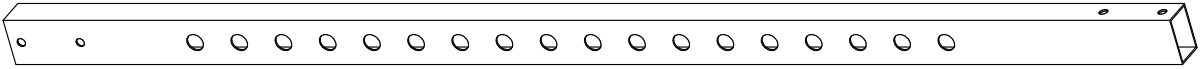

C [1PCS]

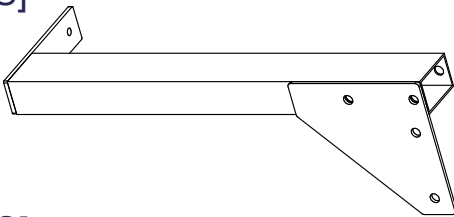

L [1PCS]

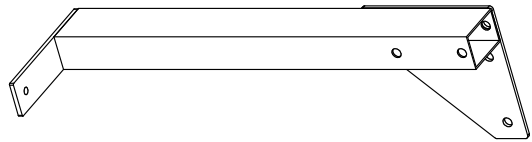

D [1PCS]

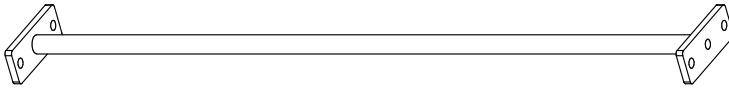

E [1PCS]

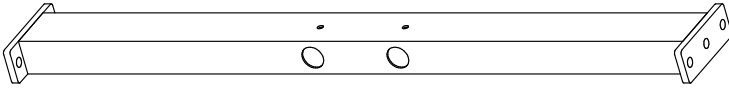

F [2PCS]

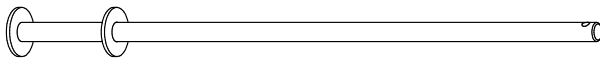

H [1PCS]

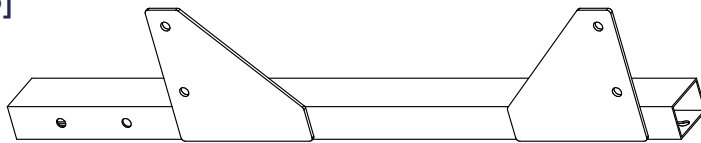

K [1PCS]

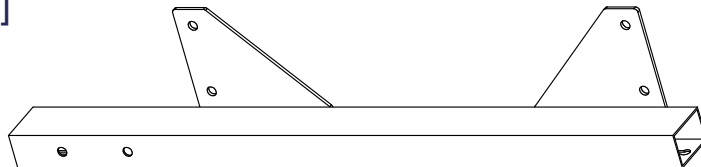

G [2PCS]

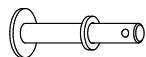

GPR-388 ASSEMBLY INSTRUCTIONS

